

# Center for Tissue, Innovation and Research

*Campaign Naming Opportunities*

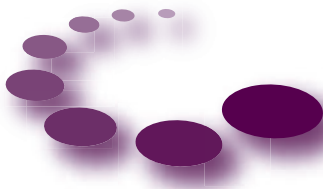

***E x c e e d i n g***  
**Expectations.**  
**Saving Lives.**



**Community**  
TISSUE SERVICES®

# Center for Tissue, Innovation and Research

## Campaign Naming Opportunities

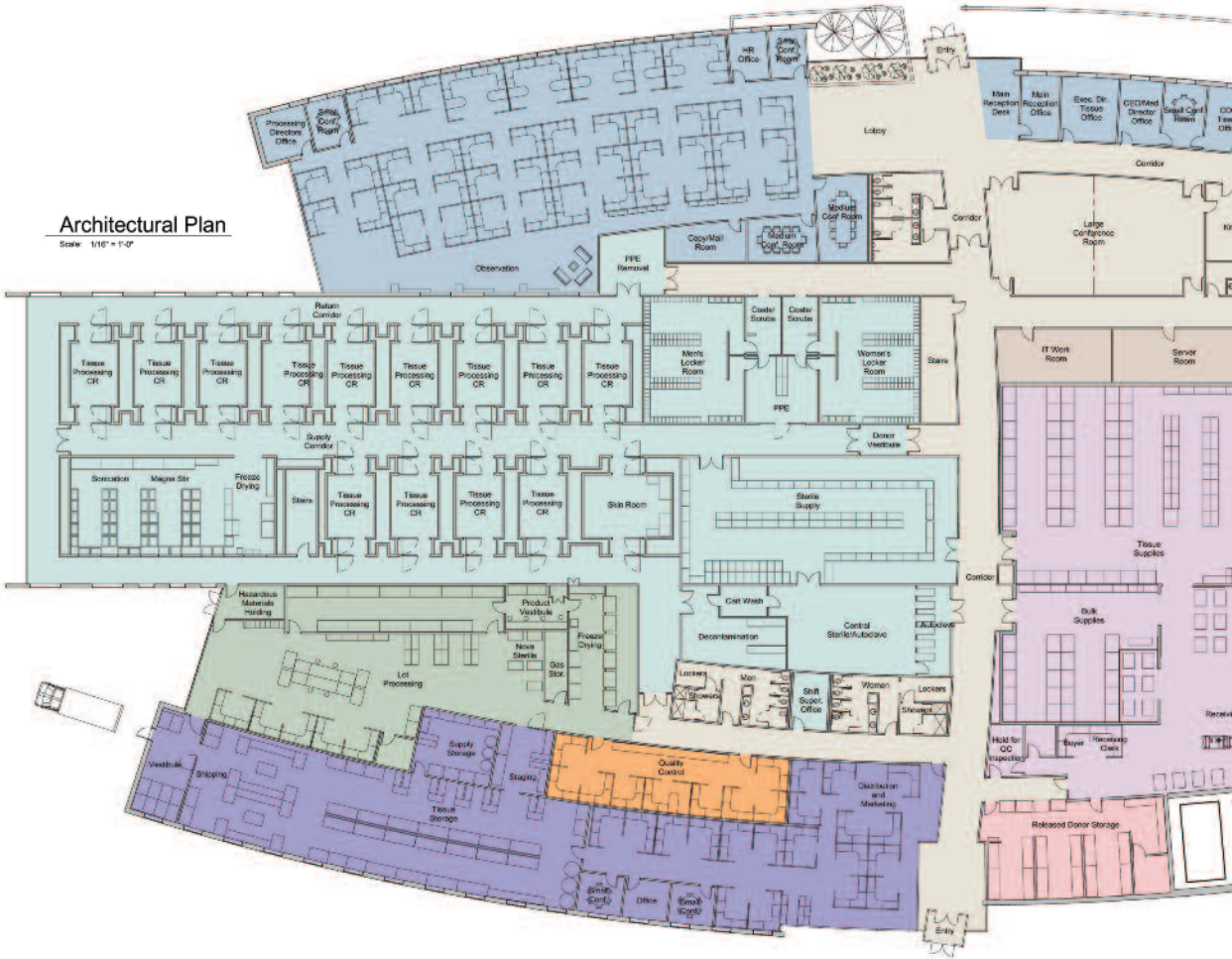

Architectural Plan

Scale: 1/16" = 1'-0"

**Campus . . . . . \$ To be determined**  
**Building . . . . . \$ To be determined**  
**Research Fund . . . . . \$2,000,000**

*A fund to bring leading-edge scientists and biotech experts to Community Tissue Services to aid the development of new tissue grafts and innovative products.*

**Research and Development Laboratory . . . . . \$500,000**

*Community Tissues Services' future in tissue banking, tissue engineering and regenerative medicine is pioneered through the R&D laboratory.*

**Entrance Circular Drive . . . . . \$250,000**

*This entrance is decorative and attractive to welcome all to the Center.*

**Lobby/Reception Area . . . . . \$250,000**

*A welcoming area of the Center for Tissue, Innovation and Research creates visitors' first impression of the Center.*

**Associate Lounge/Café . . . . . \$200,000**

*An area for relaxing, rejuvenating and sharing breakfast, lunch, dinner or a snack with co-workers, clinicians, other industry partners and visitors.*

**Clean Room Observation Wall . . \$150,000**

*A respectful area that highlights the cutting edge technology required to transform the gift of donated tissue into grafts needed by patients worldwide.*

**Reflection Pool/Pond . . . . . \$150,000**

*A restful area for reflecting and honoring donors and donor families.*

**Patio/Pavilion . . . . . \$150,000**

*An outdoor patio terrace and pavilion area that overlooks the landscaped grounds and pond.*

**Isolated Labs . . . . . 2 at \$100,000 each**

*These labs will support future innovations in biotechnology, tissue engineering and regenerative medicine.*

**Department Legend**

- Administration
- Common Areas
- Distribution and Marketing
- Facilities Management
- Lot Processing
- Purchasing
- Quality Control
- Released Donor Storage
- Research and Development
- Tissue Manufacturing



**Large Conference**

**Rooms . . . . . 2 at \$75,000 each**

*A comfortable meeting environment which provides state-of-the-art audio and visual capabilities where new ideas are explored and created, and where collaborative decisions are reached. These areas are also available for other organizations to host meetings.*

**Clean Rooms . . . . . 13 at \$50,000 each**

*The bulk of Community Tissue Services' manufacturing processes happen in state-of-the-art clean rooms that meet the highest industry standards and provide the ideal environment to create tissue grafts and products patients need.*

**Skin Clean Room . . . . . \$75,000**

*This is where life-saving skin is prepared for patients suffering from severe burns.*

**Directors' Offices . . . . . 3 at \$50,000 each**

**Distribution/Marketing Area . . . \$50,000**

*This dedicated area operates 24/7, and is where finished tissue grafts are requested and shipped across the U.S. and around the world.*

**Information Technology**

**Server Room . . . . . \$35,000**

*This dedicated room is the nerve center for Community Tissue Services, allowing communication among Community Tissue Services' locations, and with hospitals, medical professionals and partners across the U.S. and around the world.*

**Quality Control Area . . . . . \$35,000**

*This area is designated to ensure the utmost safety and quality of the life-saving and life enhancing grafts and products Community Tissue Services provides.*

**Kitchenette . . . . . \$35,000**

**Conference Rooms**

**Executive . . . . . \$30,000**

**Medium . . . . . 3 at \$25,000 each**

**Small . . . . . 4 at \$20,000 each**

**Inspection Room . . . . . \$25,000**

**Locker Rooms**

**(Men's and Women's) . . . . . \$25,000**

*These rooms provide a changing/storage area for the dedicated and highly trained technicians who transform tissue donor gifts into grafts and products which help to restore people's lives.*

**Information Technology**

**Work Room . . . . . \$25,000**

**Copy/Mail Room . . . . . \$20,000**

*The "nuts and bolts" of the office environment.*

**Maintenance Shop . . . . . \$20,000**

*This area keeps the Center for Tissue, Innovation and Research operating safely, efficiently and effectively.*

**Flagpoles . . . . . 3 at \$10,000 each**

*Show your patriotism by naming a flagpole to proudly fly the United States of America flag or the State of Ohio flag. Or, give thanks and support for tissue and organ donation by naming a flagpole for the "Donate Life" flag.*

**Benches/Plaques**

**in Gardens . . . . . 10 at \$5,000 each**

**Artwork for Public Spaces . . . \$2,500 each**



**CORPORATE OFFICES**

349 South Main Street  
Dayton, Ohio 45402  
937.461.3450  
800.684.7783  
[www.communitytissue.org](http://www.communitytissue.org)  
[www.cbccts.org](http://www.cbccts.org)



**Community**  
TISSUE SERVICES®